



## BMG-Series Explosion-proof Seal Fittings

### 1 Application and Features

- Explosion protection  
-GB
- Application in hazardous area  
Zone 1 and Zone 2  
Zone 20, Zone 21 and Zone 22
- This product has 4 types for selection: LI, LII, H,P;
- Widely used in the isolation and sealing between pipe and the pipeline in the electrical circuit, and between the pipeline and the explosion-proof cavity.



LI



LII



P



H

### 2 Formation of Marking

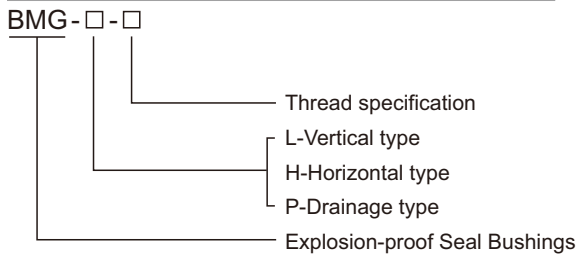

### 3 Technical Parameter

Explosion protection	Gas explosion protection	Ex d IIC Gb					
	Dust explosion protection	Ex tD A20 IP66					
Conformity to standards		GB3836.1,GB3836.2,GB12476.1,GB12476.5					
Enclosure material		Aluminum alloy enclosure, powder coated, Industrial grey with dark lines (RAL7035)					
Degree of protection		IP66					
Ambient temperature		-20℃~+40℃					
Structure code		LI、LII、H、P					
Connection thread		G1/2~G2 as standard;Special requirements, such as Metric thread (M) (pitch 1.5mm), NPT thread, please specify when ordering. No filling compound is supplied when delivery as standard, please specify when ordering.					
Cable entries	Thread	G1/2	G3/4	G1	G11/4	G11/2	G2
		NPT1/2	NPT3/4	NPT1	NPT11/4	NPT11/2	NPT2
		M20X1.5	M25X1.5	M32X1.5	M40X1.5	M50X1.5	M63X1.5
	Cable outer diameter (mm)	φ 7~ φ 10	φ 9~ φ 14	φ 12~ φ 18	φ 15~ φ 26	φ 18~ φ 30	φ 25~ φ 37

### 4 Weight

Thread specification			Type	Weight (kg)	Type	Weight (kg)	Type	Weight (kg)	Type	Weight (kg)
G	NPT	M								
G1/2	NPT1/2	M20X1.5	BMG-LI	0.10	BMG-LII	0.11	BMG-H	0.20	BMG-P	0.22
G3/4	NPT3/4	M25X1.5	BMG-LI	0.10	BMG-LII	0.17	BMG-H	0.18	BMG-P	0.19
G1	NPT1	M32X1.5	BMG-LI	0.19	BMG-LII	0.23	BMG-H	0.22	BMG-P	0.24
G11/4	NPT11/4	M40X1.5	BMG-LI	0.32	BMG-LII	0.36	BMG-H	0.28	BMG-P	0.30
G11/2	NPT11/2	M50X1.5	BMG-LI	0.27	BMG-LII	0.43	BMG-H	0.47	BMG-P	0.48
G2	NPT2	M63X1.5	BMG-LI	0.47	BMG-LII	0.65	BMG-H	0.58	BMG-P	0.59

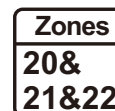
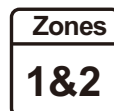
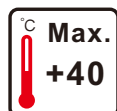



# BMG-Series Explosion-proof Seal Fittings

## 5 Outline Dimension

Type Dimension			BMG-LI-□		BMG-LII-□		BMG-H-□		BMG-P-□	
			A (mm)	B (mm)	A (mm)	B (mm)	A (mm)	B (mm)	A (mm)	B (mm)
G1/2	NPT1/2	M20X1.5	70	52	78.5	52	80	73	80	85
G3/4	NPT3/4	M25X1.5	70	58.5	84	59.5	80	77	80	86
G1	NPT1	M32X1.5	90	75	98	69.5	90	82	90	91
G1 1/4	NPT1 1/4	M40X1.5	110	92.5	110	90.5	106	101	106	103
G1 1/2	NPT1 1/2	M50X1.5	110	92.5	122	98	118	107	120	109
G2	NPT2	M63X1.5	130	110	133	113	128	120	128	122

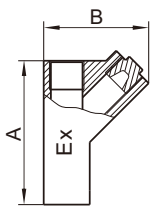

BMG-L I

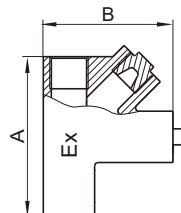

BMG-L II

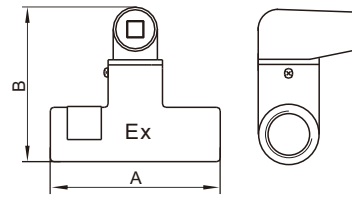

BMG-H

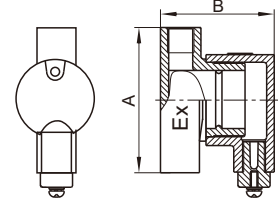

BMG-P

## 6 Installation Schematic View

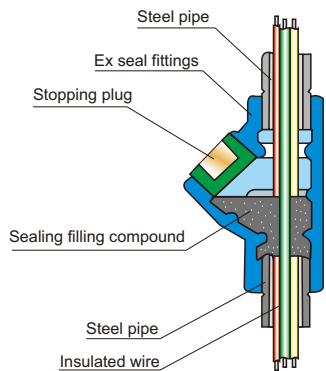

BMG-L I

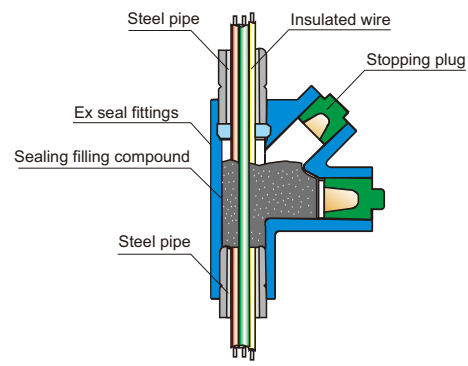

BMG-L II

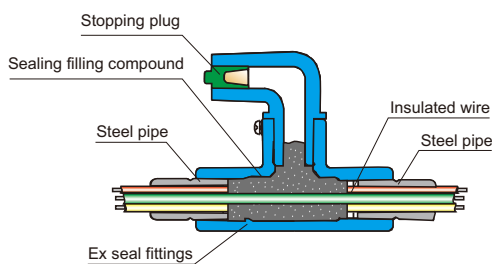

BMG-H

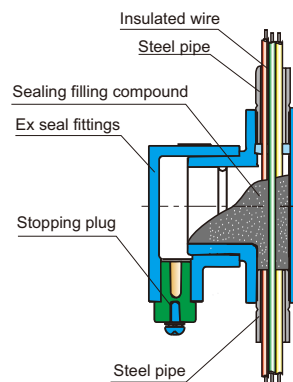

BMG-P